

TIRE: Medium-Heavy Cruiser/Dual Sport tires

METHOD: 3 SpoonBar Mount

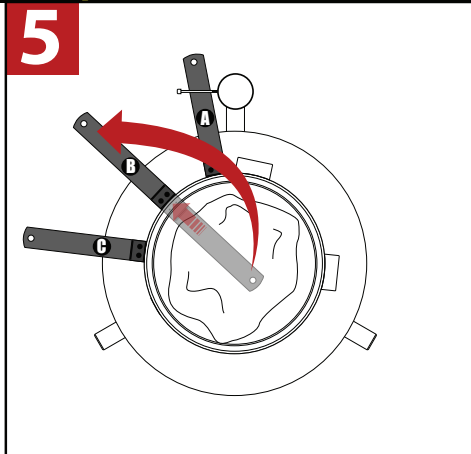
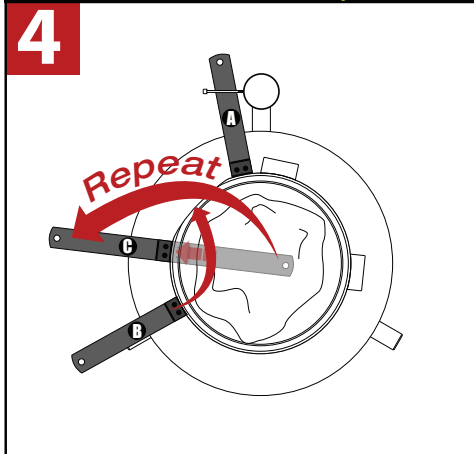

Theory

Wooden blocks push the tire bead **Into** the **relief valley**, making it easier to flip the spoon bar on the opposite side of the rim.

The strength, and length of the **SpoonBar** creates high leverage, while the protective tips prevent scratching or marring the rim.

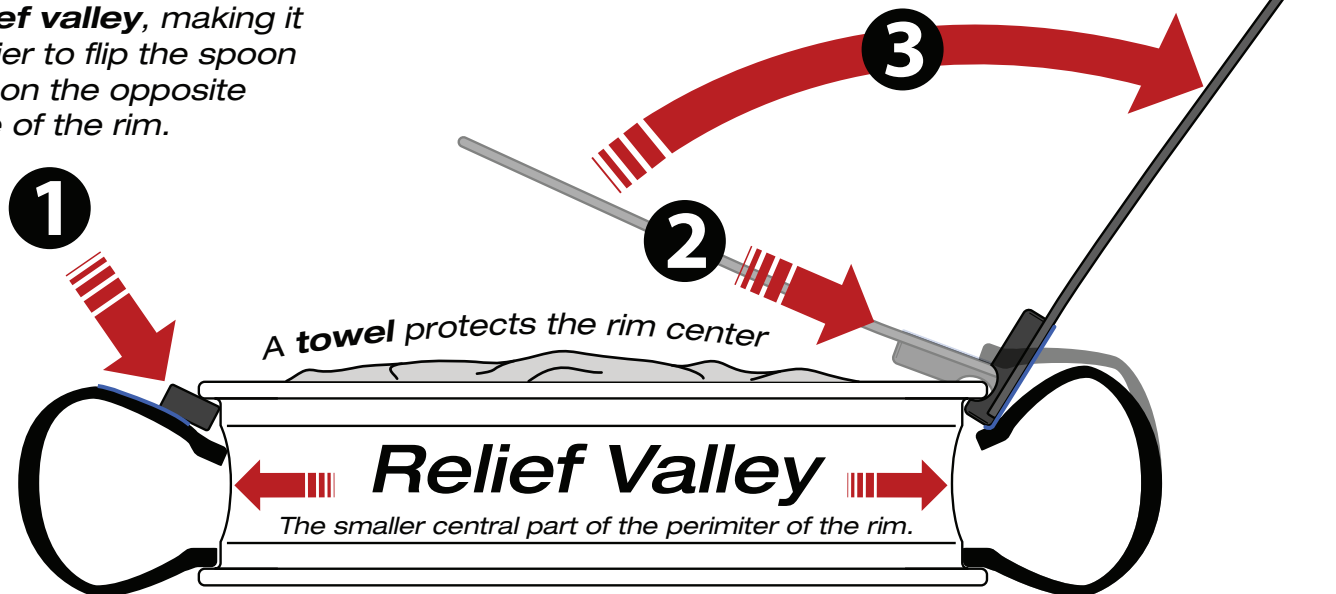

Apply a very thin layer of No-Mar paste lube on the back of the SpoonBar tip, and the tire surface in contact with the wooden block.

For more detailed instructions see our complete *video library* online at www.NoMarTireChanger.com