



Jr Pro Model Assembly Instructions

Machine Parts

- A** Stand Post
- B** Stand Bottom Plate
- C** Stand Top Plate
- D** Frame
- E** Back Post
- F** Collar (2)
- G** Tab Collar
- Ga** Spoon Bar Collar
- H** Bead Breaker Arm
- I** Bead Breaker "T"
- J** Upper Arm
- Ja** Upper Arm "T" (2 halves)
- K** Center Post
- L** Dog Block (2)
- M** Cam Block
- N** Mount/Demount Bar
- O** M/D Bar Handle

Assembly Parts

- P** 5/16" x 5/16" Set Screw (8)
- Q** 1/2" x 1" Hex Bolt (3)
- R** 1/2" Washer (3)
- S** 5/16" x 3/4" Flat Socket Head Screw (8)
- T** 3" Carriage Bolt and Locking Lever (3 each)
- U** 5/16" x 1/2" Flat Socket Head Screw (12)
- V** 5/16" x 3/4" Shoulder Bolt (2)
- X** 1/4" Nyloc Nut (2)
- Y** Small Knob (1)
- Z** 5/16" x 3" Socket Head Bolt (2)
- AA** Replacement Tip Pt# DTB
- BB** 3/16" Allen Wrench (stand)
- CC** 5/32" Allen Wrench
- DD** 5/16" x 1/4" set screw

Replacement Tip (Part #: DT3B)

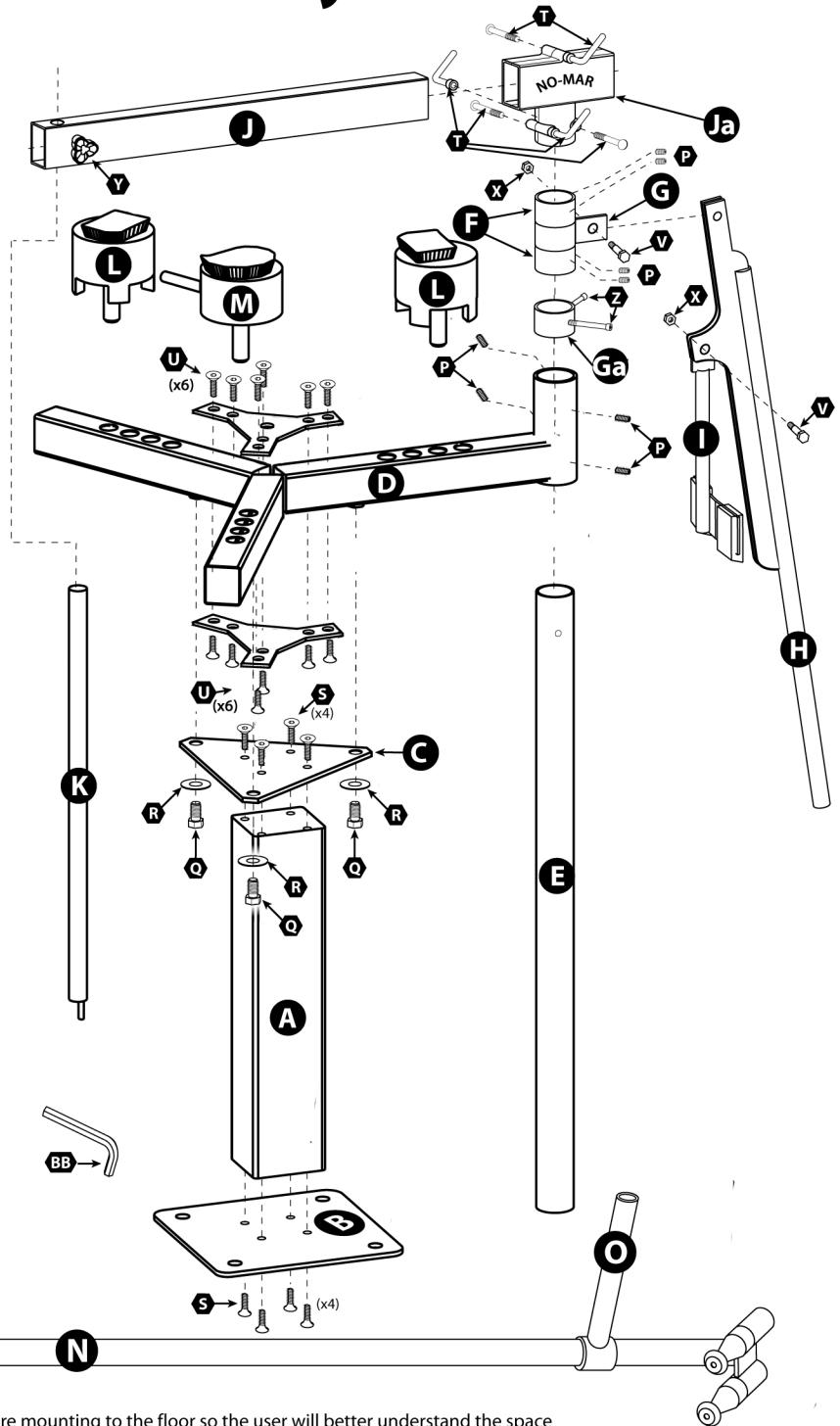

Jr Pro Tire Changer Assembly Instructions

Changer Placement: It is recommended assembling the tire changer before mounting to the floor so the user will better understand the space needed for the changer and changer tools.

- STEP 1** Attach Stand Base (B) and Stand Top (C) to Stand Post (A) Using (8) Screws (S) with thread lock sealant¹ (included). Make sure all threads of all 4 bolts are started before tightening down.
- STEP 2** Attach 3 frame pieces (D) using 2 triangle plates (hole on top), fastening with 6 screws (Z) on either side.
- STEP 3** Attach Frame (D) to the Machine Stand Assembly, using 3 hex bolts (Q) and washers (R).
- STEP 4** Slide Back Post (E) into the top of the Frame (D). Attach with 4 set screws (P).
- STEP 5** Secure one Collar (F) onto the Back Post approximately 18" above Frame Arm by tightening 2 screws (P).
- STEP 6** Slide Clevis Collar (G) onto Back Post and leave loose. This part needs to spin freely.
- STEP 7** Secure the second Collar (F) onto the Back Post approximately 1/8" above Clevis Collar (G) by tightening 2 screws (P).
- STEP 8** Attach Bead Breaker Arm (H) to the Tab Collar (G), (between the tabs) using one shoulder bolt (V) and one Nyloc nut (X).
- STEP 9** Attach Bead Breaker "T" (I) to the Bead Breaker Arm (H) using one shoulder bolt (V) and one Nyloc nut (X).
- STEP 10** Position the Upper Arm "T" (Ja) over the Back Post as shown. Secure with Bolt and Lever (T) Slide the Upper Arm (J) in to the Upper Arm "T", as shown.
- STEP 11** Insert the Center Post into the hole on the end of the Upper Arm. Hold in position using the Small Knob (Y) on the side. Adjust the Center post height according to the wheel and tire combination you are changing. Adjust back post height per requirement, see assembly video for details. See website for complete tire changing instructions and videos.

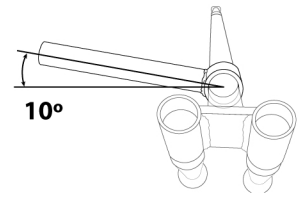

REPLACEMENT TIP

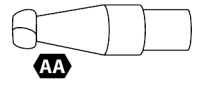

¹Pre-installed **Parts, labels, names, drawings, pricing and availability are subject to change without notice. See website for most current information.